

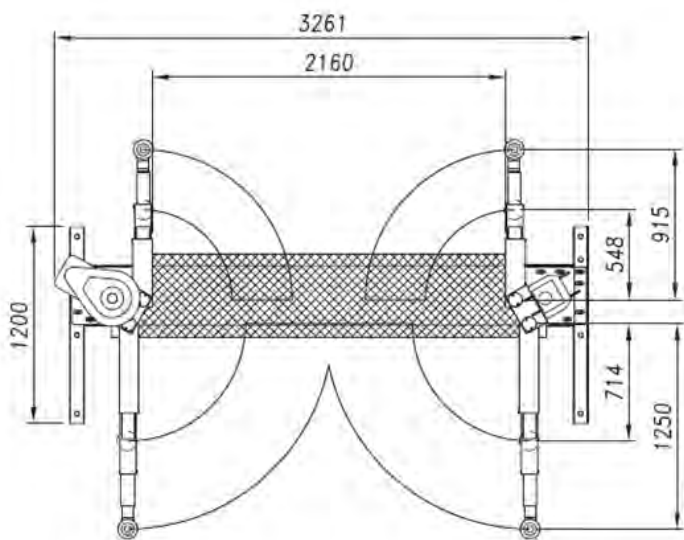

- 3.0t Lifting capacity
- 90mm Min. pad height
- 1.9m Max. lifting height
- 2.1m Drive-through width
- Asymmetric lifting arms
- Electro-mechanical operation

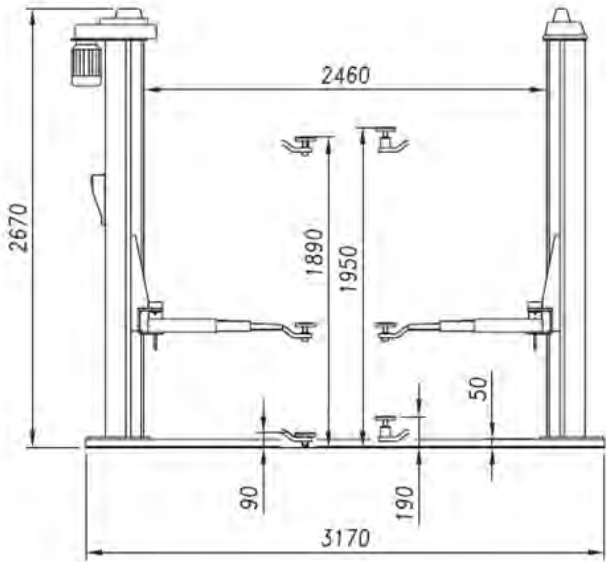

Accessories

Lifting pad extensions

- 60mm - L956 (*included as standard*)
- 100mm - L953
- 170mm - L954
- 250mm - L955

Specifications

- Front arm range: 548-915mm
- Rear arm range: 714-1250mm
- Power supply: 400V 3ph/50Hz
- Motor power: 4.5kW
- Vehicle types: Car, Light Commercial Vehicle
- Lifting capacity: 3000kg
- Lifting/lowering time: 55 secs
- Installation type: Standard base H-frame
- Concrete floor min. thickness: 150mm
- Overall height: 2670mm
- Net weight: 565kg

Muller Automotive UK Ltd

Unit 15 Hearder Court,
Beechwood Way,
Plymouth, PL7 5HH
01752 929 929

Sales@MullerAutomotive.co.uk

E&OE. This document's content and data (text and images) are not contractual and subject to change, developments, or improvements, particularly technical ones.